

EVERPLAY Play Mats 54 as access through play area ENGINEERED Wood Fibre

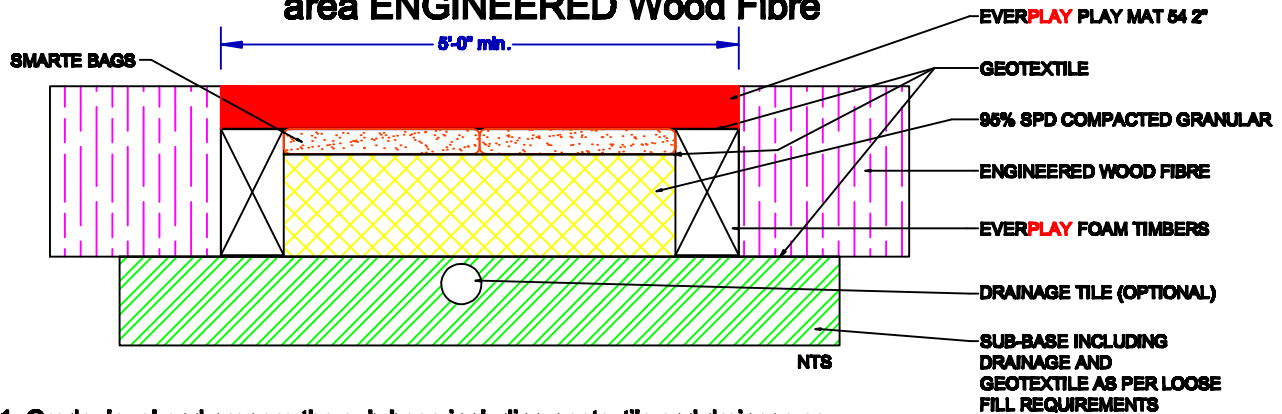

1. Grade, level and prepare the sub-base including geotextile and drainage as required.
2. Place the granular retention, recommended is foam timber, to the depth of the loose fill material.
3. Install and compact split granular with fines to 95% standard proctor density.
4. Place geotextile (Terrafix 200R) across the granular and across and down the retention.
5. Place the EVERPLAY Play Mat 54, bonding the mats to each other and timber using EVERPLAY adhesive at the edges.
6. Install loose fill materials to the specification of the loose fill material supplier.

EVERPLAY Play Mats 44 in high traffic areas for ENGINEERED Wood Fibre

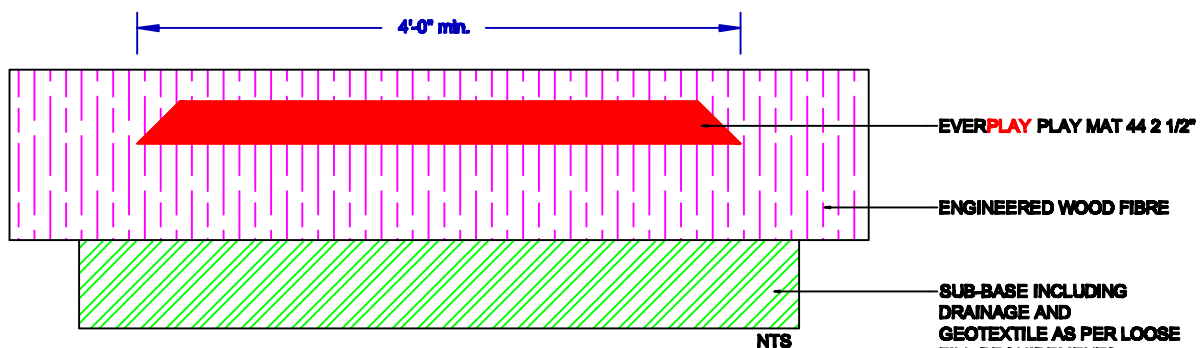

1. Grade, level and prepare the sub-base including any geotextile and drainage as required.
2. Install loose fill materials to the specification of the loose fill material supplier to a depth 4" (100mm) below final grade.
3. Place the EVERPLAY 44 2 1/2" Play Mat.
4. Allow the EVERPLAY play mat 44 to settle into the granite sand.
5. Install balance of loose fill materials to the specification of the loose fill material supplier.